



Smart Fittings Manager App Quick Guide

View your sensor live loads and more on our [smartphone app](#) - point your phone camera at the QR code above to download the app.

Add a sensor

Video available at <https://youtu.be/ZMVw428G-nc>

iOS

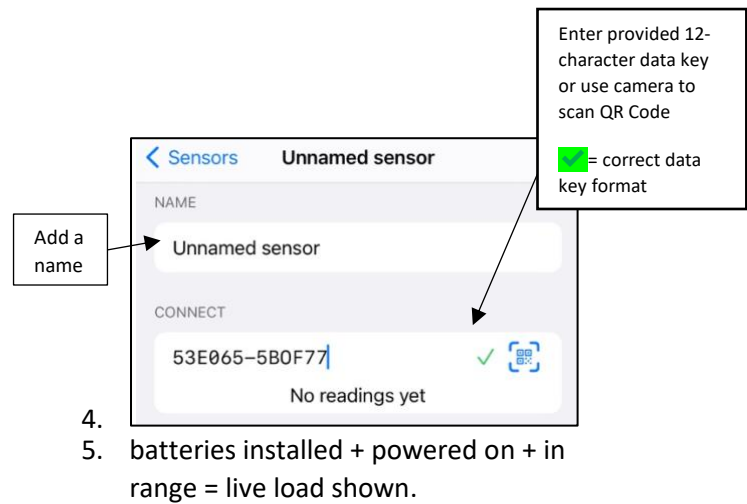
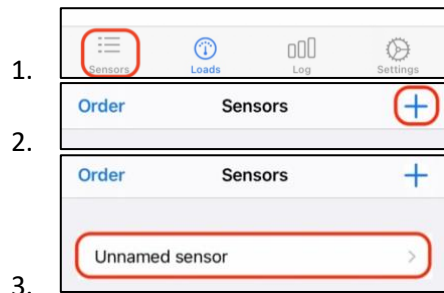

Android

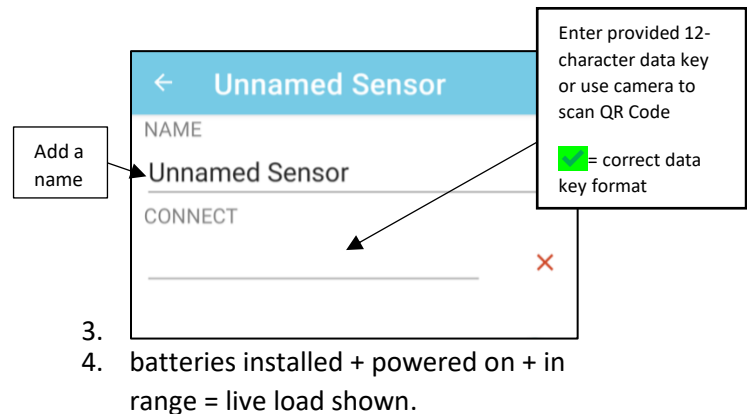
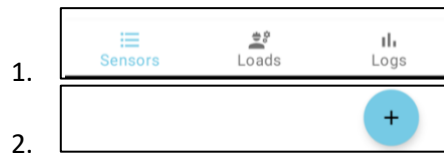



Sensor Detail Page explained

SETTINGS

Enabled = show/hide on 'Loads' page.

Units = changes what units the load is shown in.

kg tonne lbf

Precision = changes the number of significant figures the load is shown in.

X. X0. X00.

Multiples of: 1 10 100

Display detail = provides more information on loads page collected while the app has been active.

simple statistics averages



Enabled

Units

kg tonne lbf

Precision

X.₁₀ X0.₁₀₀

Display detail

Simple Statistics Averages

'Statistics' = minimum, maximum and average of the sensor load.

'averages' = shows 1, 10 and 30min averages

min	avg	max	1 min	10 min	30 min
30	30	30	30	30	30

QR Code of data key, useful for transferring sensor data key to other devices.



Log page explained

PLEASE NOTE: When logging a session using the iOS app:

- the phone must be unlocked
- the app must always be in the foreground
- the display must be set to never sleep
(iOS settings->Display & Brightness->Auto-Lock->Never).

Otherwise, the session log data will be lost. Walkthrough at bit.ly/3qKVgzT

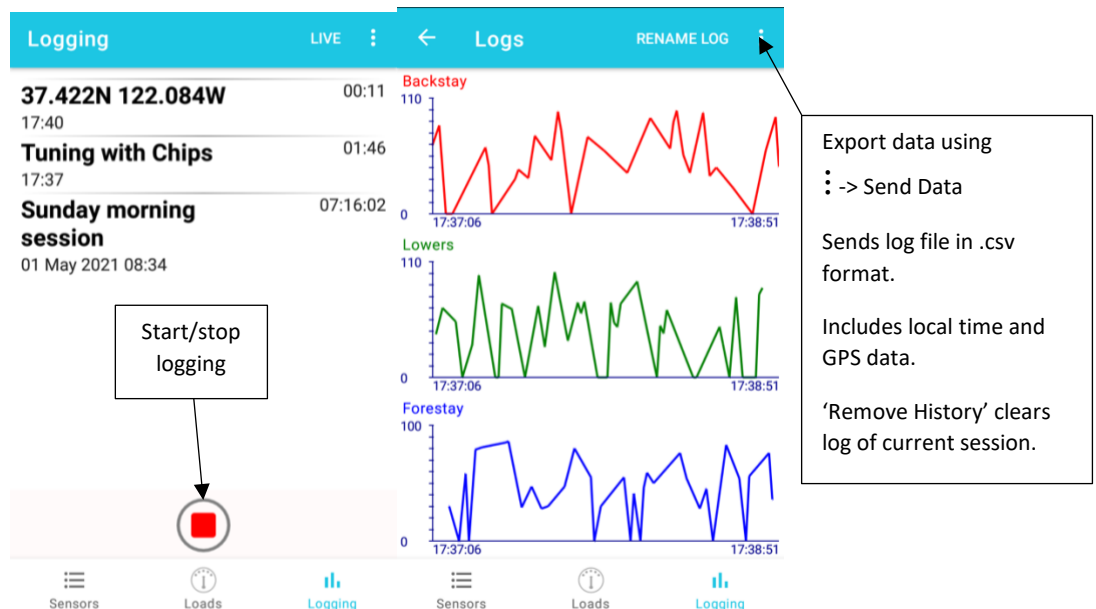
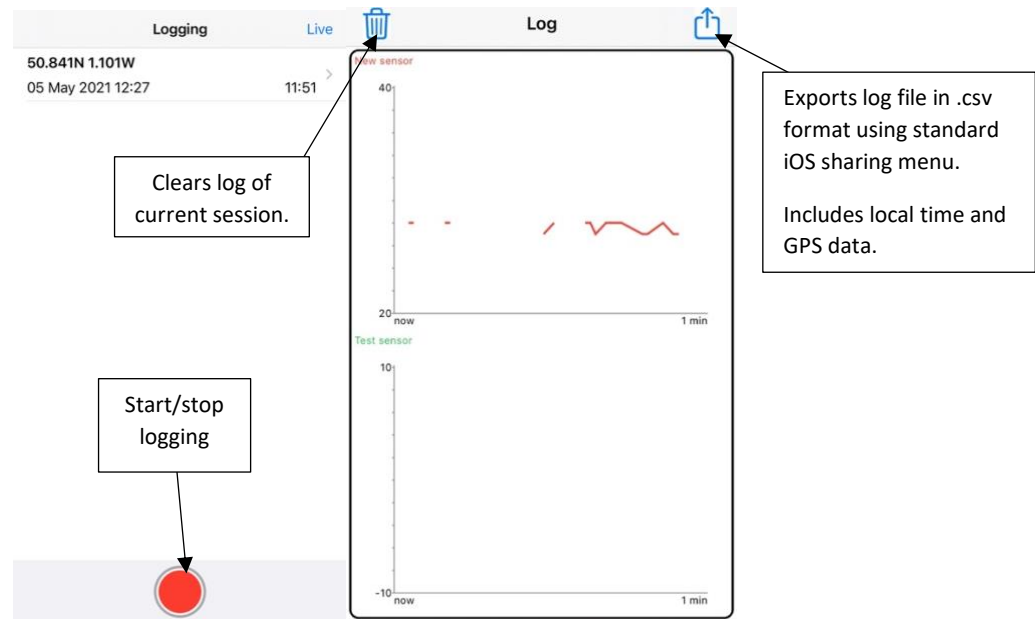



Settings page explained

iOS

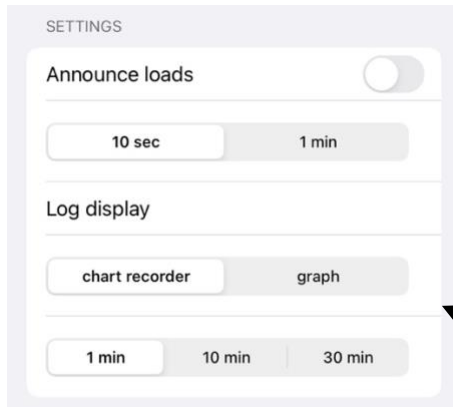

Announces live loads using Siri voice every 10 sec or 1min.

Changes Log display as above.

Android

Access settings page using  button in top right.

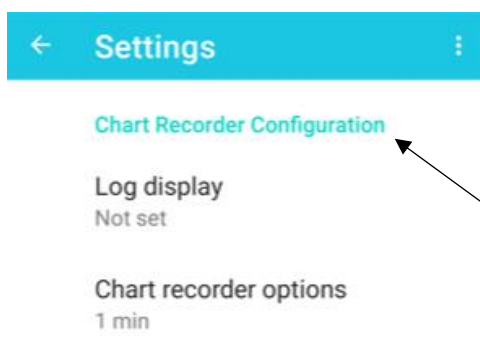
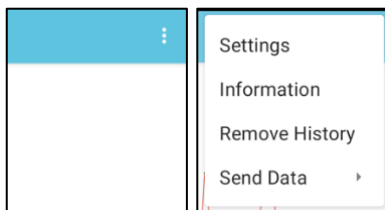

Changes Log display as above.

Application Configuration

Dark Mode
Light

Changes application theme between Light & Dark

Create log information for Cyclops Marine Support

Creates app troubleshooting log to send to Cyclops Marine